

MATERIAL

Aluminium, matte finish.
AISI 304 stainless steel screws and nuts.

STANDARD EXECUTIONS

- **GN 171-B:** for round tubes.
- **GN 171-V:** for square tubes.

Surface finish index:

BL: natural colour.

SW: epoxy resin coating, RAL 9005 black colour.

FEATURES AND APPLICATIONS

The assembly hole of GN 171 connecting clamps allows an excellent match with tubes GN 990 (see page 1368).

The clamping screw d3 may be replaced by clamping kit GN 911 (see page 1372).



Conversion Table
1 mm = 0.039 inch

| d1 | |
|----|------|
| mm | inch |
| 20 | 0.78 |
| 25 | 0.98 |
| 30 | 1.17 |
| 40 | 1.56 |
| 42 | 1.64 |
| 45 | 1.76 |
| 48 | 1.87 |
| 50 | 1.95 |
| 60 | 2.34 |

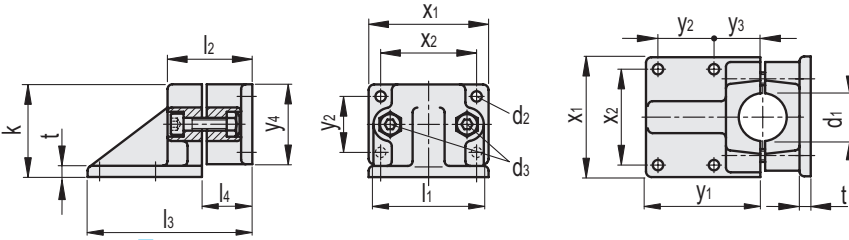
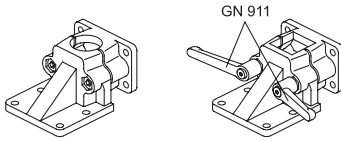

GN 171-B

| Code | Description | d1 Hole | d2 | d3 | k | l1 | l2 | l3 | l4 | t | x1 | x2 | y1 | y2 | y3 | y4 | d3 Clamping kit | △ |
|----------|-----------------|---------|----|-----|-----|-------|----|-----|------|----|-----|-----|-----|----|------|----|--------------------------------------|-----|
| GN.50611 | GN 171-B20-2-BL | 20 | 7 | M8 | 58 | 69 | 53 | 103 | 30 | 7 | 75 | 60 | 72 | 35 | 30 | 50 | GN 911-63-M8-40 GN 911-78-M8-40 | 344 |
| GN.50631 | GN 171-B25-2-BL | 25 | 7 | M8 | 58 | 69 | 53 | 103 | 30 | 7 | 75 | 60 | 72 | 35 | 30 | 50 | GN 911-63-M8-40 GN 911-78-M8-40 | 337 |
| GN.50651 | GN 171-B30-2-BL | 30 | 7 | M8 | 58 | 69 | 53 | 103 | 30 | 7 | 75 | 60 | 72 | 35 | 30 | 50 | GN 911-63-M8-40 GN 911-78-M8-40 | 330 |
| GN.50671 | GN 171-B40-2-BL | 40 | 11 | M10 | 91 | 98 | 82 | 156 | 46.5 | 14 | 115 | 90 | 108 | 50 | 45 | 76 | GN 911-78-M10-78 GN 911-92-M10-92 | 995 |
| GN.50691 | GN 171-B42-2-BL | 42 | 11 | M10 | 91 | 98 | 82 | 156 | 46.5 | 14 | 115 | 90 | 108 | 50 | 45 | 76 | GN 911-78-M10-78 GN 911-92-M10-92 | 982 |
| GN.50711 | GN 171-B45-2-BL | 45 | 11 | M10 | 91 | 98 | 82 | 156 | 46.5 | 14 | 115 | 90 | 108 | 50 | 45 | 76 | GN 911-78-M10-78 GN 911-92-M10-92 | 973 |
| GN.50731 | GN 171-B48-2-BL | 48 | 11 | M10 | 91 | 98 | 82 | 156 | 46.5 | 14 | 115 | 90 | 108 | 50 | 45 | 76 | GN 911-78-M10-78 GN 911-92-M10-92 | 698 |
| GN.50751 | GN 171-B50-2-BL | 50 | 11 | M10 | 91 | 98 | 82 | 156 | 46.5 | 14 | 115 | 90 | 108 | 50 | 45 | 76 | GN 911-78-M10-78 GN 911-92-M10-92 | 959 |
| GN.50761 | GN 171-B60-2-BL | 60 | 11 | M10 | 100 | 108.5 | 97 | 186 | 56 | 14 | 125 | 100 | 128 | 52 | 65.5 | 90 | - | 942 |
| GN.50616 | GN 171-B20-2-SW | 20 | 7 | M8 | 58 | 69 | 53 | 103 | 30 | 7 | 75 | 60 | 72 | 35 | 30 | 50 | GN 911-63-M8-40 GN 911-78-M8-40 | 344 |
| GN.50636 | GN 171-B25-2-SW | 25 | 7 | M8 | 58 | 69 | 53 | 103 | 30 | 7 | 75 | 60 | 72 | 35 | 30 | 50 | GN 911-63-M8-40 GN 911-78-M8-40 | 337 |
| GN.50656 | GN 171-B30-2-SW | 30 | 7 | M8 | 58 | 69 | 53 | 103 | 30 | 7 | 75 | 60 | 72 | 35 | 30 | 50 | GN 911-63-M8-40 GN 911-78-M8-40 | 330 |
| GN.50676 | GN 171-B40-2-SW | 40 | 11 | M10 | 91 | 98 | 82 | 156 | 46.5 | 14 | 115 | 90 | 108 | 50 | 45 | 76 | GN 911-78-M10-78 GN 911-92-M10-92 | 995 |
| GN.50696 | GN 171-B42-2-SW | 42 | 11 | M10 | 91 | 98 | 82 | 156 | 46.5 | 14 | 115 | 90 | 108 | 50 | 45 | 76 | GN 911-78-M10-78 GN 911-92-M10-92 | 982 |
| GN.50716 | GN 171-B45-2-SW | 45 | 11 | M10 | 91 | 98 | 82 | 156 | 46.5 | 14 | 115 | 90 | 108 | 50 | 45 | 76 | GN 911-78-M10-78 GN 911-92-M10-92 | 973 |
| GN.50736 | GN 171-B48-2-SW | 48 | 11 | M10 | 91 | 98 | 82 | 156 | 46.5 | 14 | 115 | 90 | 108 | 50 | 45 | 76 | GN 911-78-M10-78 GN 911-92-M10-92 | 698 |
| GN.50756 | GN 171-B50-2-SW | 50 | 11 | M10 | 91 | 98 | 82 | 156 | 46.5 | 14 | 115 | 90 | 108 | 50 | 45 | 76 | GN 911-78-M10-78 GN 911-92-M10-92 | 959 |
| GN.50762 | GN 171-B60-2-SW | 60 | 11 | M10 | 100 | 108.5 | 97 | 186 | 56 | 14 | 125 | 100 | 128 | 52 | 65.5 | 90 | - | 942 |

| Conversion Table | |
|-------------------|------|
| 1 mm = 0.039 inch | |
| s | |
| mm | inch |
| 20 | 0.78 |
| 25 | 0.98 |
| 30 | 1.17 |
| 40 | 1.56 |
| 45 | 1.76 |
| 50 | 1.95 |
| 60 | 2.34 |

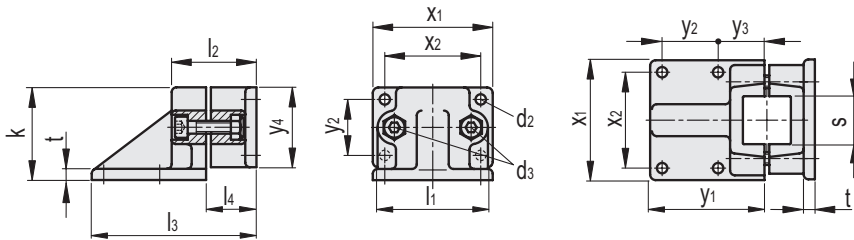

GN 171-V

METRIC

| Code | Description | s Square hole | d2 | d3 | k | l1 | l2 | l3 | l4 | t | x1 | x2 | y1 | y2 | y3 | y4 | d3 Clamping kit | ⚖ |
|----------|-----------------|------------------|----|-----|-----|-------|----|-----|------|----|-----|-----|-----|----|------|----|--------------------------------------|-----|
| GN.50811 | GN 171-V20-2-BL | 20x20 | 7 | M8 | 58 | 69 | 53 | 103 | 30 | 7 | 75 | 60 | 72 | 35 | 30 | 50 | GN 911-63-M8-40 GN 911-78-M8-40 | 343 |
| GN.50831 | GN 171-V25-2-BL | 25x25 | 7 | M8 | 58 | 69 | 53 | 103 | 30 | 7 | 75 | 60 | 72 | 35 | 30 | 50 | GN 911-63-M8-40 GN 911-78-M8-40 | 326 |
| GN.50851 | GN 171-V30-2-BL | 30x30 | 7 | M8 | 58 | 69 | 53 | 103 | 30 | 7 | 75 | 60 | 72 | 35 | 30 | 50 | GN 911-63-M8-40 GN 911-78-M8-40 | 316 |
| GN.50871 | GN 171-V40-2-BL | 40x40 | 11 | M10 | 91 | 98 | 82 | 156 | 46.5 | 14 | 115 | 90 | 108 | 50 | 45 | 76 | GN 911-78-M10-78 GN 911-92-M10-92 | 981 |
| GN.50891 | GN 171-V45-2-BL | 45x45 | 11 | M10 | 91 | 98 | 82 | 156 | 46.5 | 14 | 115 | 90 | 108 | 50 | 45 | 76 | GN 911-78-M10-78 GN 911-92-M10-92 | 958 |
| GN.50911 | GN 171-V50-2-BL | 50x50 | 11 | M10 | 91 | 98 | 82 | 156 | 46.5 | 14 | 115 | 90 | 108 | 50 | 45 | 76 | GN 911-78-M10-78 GN 911-92-M10-92 | 918 |
| GN.50921 | GN 171-V60-2-BL | 60x60 | 11 | M10 | 100 | 108.5 | 97 | 186 | 56 | 14 | 125 | 100 | 128 | 52 | 65.5 | 90 | - | 964 |
| GN.50816 | GN 171-V20-2-SW | 20x20 | 7 | M8 | 58 | 69 | 53 | 103 | 30 | 7 | 75 | 60 | 72 | 35 | 30 | 50 | GN 911-63-M8-40 GN 911-78-M8-40 | 343 |
| GN.50836 | GN 171-V25-2-SW | 25x25 | 7 | M8 | 58 | 69 | 53 | 103 | 30 | 7 | 75 | 60 | 72 | 35 | 30 | 50 | GN 911-63-M8-40 GN 911-78-M8-40 | 326 |
| GN.50856 | GN 171-V30-2-SW | 30x30 | 7 | M8 | 58 | 69 | 53 | 103 | 30 | 7 | 75 | 60 | 72 | 35 | 30 | 50 | GN 911-63-M8-40 GN 911-78-M8-40 | 316 |
| GN.50876 | GN 171-V40-2-SW | 40x40 | 11 | M10 | 91 | 98 | 82 | 156 | 46.5 | 14 | 115 | 90 | 108 | 50 | 45 | 76 | GN 911-78-M10-78 GN 911-92-M10-92 | 981 |
| GN.50896 | GN 171-V45-2-SW | 45x45 | 11 | M10 | 91 | 98 | 82 | 156 | 46.5 | 14 | 115 | 90 | 108 | 50 | 45 | 76 | GN 911-78-M10-78 GN 911-92-M10-92 | 958 |
| GN.50916 | GN 171-V50-2-SW | 50x50 | 11 | M10 | 91 | 98 | 82 | 156 | 46.5 | 14 | 115 | 90 | 108 | 50 | 45 | 76 | GN 911-78-M10-78 GN 911-92-M10-92 | 918 |
| GN.50922 | GN 171-V60-2-SW | 60x60 | 11 | M10 | 100 | 108.5 | 97 | 186 | 56 | 14 | 125 | 100 | 128 | 52 | 65.5 | 90 | - | 964 |



Tube connectors